



VL-SVD273:
Wireless monitors sold separately

Key Features

- Highly Expandable:** Up to 6 additional monitors can be connected to the main monitor using a combination of 7-inch wired monitors and 2.2-inch wireless monitors (However, the maximum possible number of 7-inch wired monitors is 3). In addition, PBX connectivity is also supported.
- Wireless Monitor:** Using the wireless monitor, check visitors and respond promptly from the living room, kitchen and elsewhere in the home even while you are doing something else. Up to 6 wireless monitors connectable. Max wireless range is 100 m with no obstacles. You can add on repeaters to expand the range. Up to 2 DECT repeaters connectable.
- 7-inch Screen:** The main monitor and extension monitor have a 7-inch wide screen that offers easy viewing of wide vertical and horizontal views.
- Voice Change Function:** This function makes woman's voice (higher keys) sounds like a man's (lower keys).
- Electric Lock Release Support for Gate:** The gate or door lock can be easily and quickly released using monitors (wired or wireless) from anywhere in the house.
- Wide-Angle Camera:** Wide-angle lens covers approximately 170 degrees horizontally and 115 degrees vertically.
- Picture Recording Function:** The main monitor and extension monitor can record doorphone images from up to 50 doorphone calls or monitoring sessions. (up to 8 still images per visitor/session)
- Night Vision with LED lights (illumination lamp):** Door station is equipped with LED lights (illumination lamp). It enables the colour display of visitors at a distance of about 50 cm at night.

Wiring Schematic Diagram

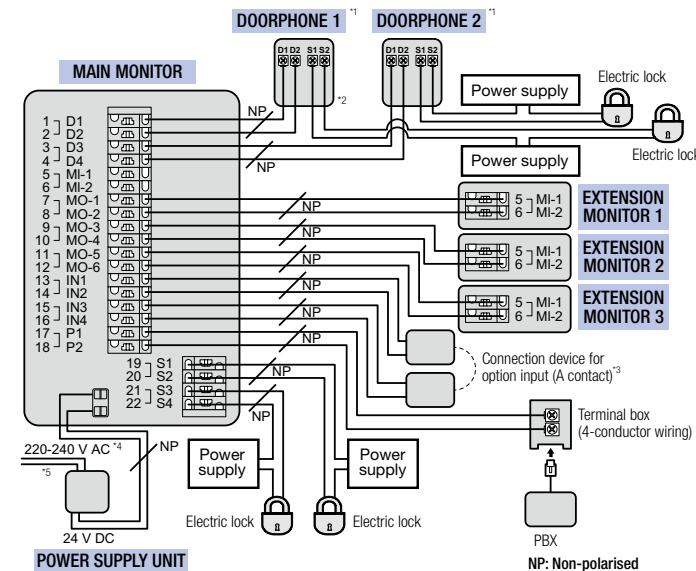

Wire type and length

Wiring run	Wire type ⁵	
	Diameter	Length (Max.)
Doorphone –	φ 0.65 mm	22 AWG
Main monitor –	φ 1.0 mm	18 AWG
Extension monitor ⁷	φ 0.5 mm	CAT 5
Main monitor –	φ 0.65 mm	22 AWG
Power supply unit	φ 1.0 mm	18 AWG
Power supply unit –	φ 1.2 mm - φ 2.0 mm (17 AWG - 12 AWG)	No requirement
Main monitor – Electric lock ⁸	φ 0.5 mm - φ 1.2 mm (24 AWG - 17 AWG)	According to the specification of connected device.
Doorphone – Electric lock ⁸	φ 0.5 mm - φ 1.2 mm (24 AWG - 17 AWG)	According to the specification of connected device.
Main monitor – Connection device for option input (A contact) ⁸	φ 0.5 mm - φ 1.2 mm (24 AWG - 17 AWG)	According to the specification of connected device.
Main monitor – PBX	φ 0.65 mm	CAT 3 or 22 AWG
		100 m

⁵Type: Single-pair cable with outer sheath (jacket)

Conductor: Copper solid

• A certified power supply wiring has to be used with this equipment. The relevant national installation and/or equipment regulations shall be considered. A certified power supply wiring not lighter than ordinary polyvinyl chloride flexible wiring according to IEC 60227 shall be used.

⁷When an extension monitor is used, make sure that the total wiring length from the doorphone to the main monitor and then to the extension monitor, is within about 100 m.

⁸When using an electric lock or a connection device for option input (A contact), select a device that meets the following guidelines:

- Electric lock connection terminal (S1/S2, S3/S4):
 - N/O dry closure contact
 - 30 V AC (1 A)/24 V DC (1 A) or lower
- Connection device for option input (A contact) terminal (IN1/IN2/IN3/IN4):
 - Input method: No-voltage contact
 - Open-circuit voltage between terminals: DC 7 V or less
 - Detection definite time: 0.1 seconds or more
 - Short-circuit between terminals: 5 mA or less
 - Resistance value: make: 500 Ω or less, break: 15 KΩ or more

¹When you use an additional doorphone, the maximum number of the electric locks that can be connected to the doorphone depends on the type of doorphone. Consult your dealer for further information.

For VL-V554 users:

- Make sure to only connect electric door locks to the S1/S2 terminals of the doorphones.

²You can also connect an optional lobby station or Video Intercom System for Apartment Complexes.

³Connection devices for option input (A contact) can be used when a VL-V900 and VL-V700 series Video Intercom System for Apartment Complexes is used.

- Make sure to connect emergency terminals to the IN1/IN2 terminals.

- Make sure to connect doorbells to the IN3/IN4 terminals. A doorbell and doorphone 2 cannot be used together.

⁴VL-MWD273BX/VL-MWD273ML models only

⁵VL-SWD273AZ/VL-SVD273AZ/ML-MWD273AZ: Use only the supplied AC cable.

Optional Accessories

Door Station (Doorphone)

CMOS 1.0 M pixels

VL-V554 (Surface mount)

VL-V554U (Flash mount)

CMOS 0.3 M pixels

VL-V555 (Surface mount)



Door Station (Doorphone)

VL-V522L
(Surface mount)



Extension Monitor

VL-MWD273
VL-MWD272

(Power source)
VL-MWD273: 24 V DC Power supply unit (supplied)
VL-MWD272: 220-240 V AC, 50/60 Hz



Wireless
Monitor Station
(Sub monitor)

VL-WD613



DECT Repeater

VL-FKD2



Lobby Station

Up to 20 main
monitors can
be connected.



Model Composition

VL-SWD273	VL-MWD273 x 1, VL-V554 x 1, VL-WD613 x 1, VL-PS241 x 1
VL-SVD273	VL-MWD273 x 1, VL-V554 x 1, VL-PS241 x 1 (VL-WD613 sold separately)

Specifications

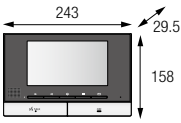
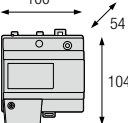
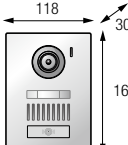
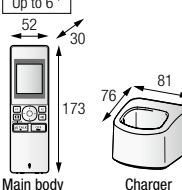
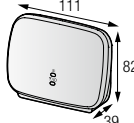
Model number and name	VL-MWD273	VL-PS241	VL-V554 VL-V554U	VL-WD613	VL-FKD2
	Main Monitor Station (Main monitor) Extension Monitor	Power supply unit	Door Station (Doorphone)	Wireless Monitor Station (Sub monitor)	DECT Repeater
Dimensions (mm)	Up to 3" ¹ (not including the main monitor) 		Up to 2 	Up to 6" ¹ 	Up to 2 
Power source	Power supply unit (VL-PS241) 24 V DC, 0.5 A	Input: 220-240 V AC, 0.2 A, 50/60 Hz Output: 24 V DC, 0.6 A	Power supplied by the main monitor 20 V DC, 0.23 A	Main body: Rechargeable Ni-MH (AAA x 2) Charger: AC adaptor (PNLV226) Input: 220-240 V AC, 0.1 A, 50/60 Hz Output: 5.5 V DC, 0.5 A	AC adaptor (PQLV219) Input: 220-240 V AC, 0.1 A, 50/60 Hz Output: 6.5 V DC, 0.5 A
Power consumption	Standby: Approx. 1.8 W During operation: Approx. 11.6 W	-	-	Standby: 0.5 W (when the sub monitor is not placed in the charger) During operation: 1.6 W	Standby: Approx. 1.5 W During operation: Approx. 2.3 W (when transmitting)
Dimensions (H x W x D) (Excluding protruding sections)	158 x 243 x 29.5 mm	104 x 100 x 54 mm	VL-V554: 169 x 118 x 30 mm VL-V554U: 169 x 118 x 16.5 mm (excluding sections embedded into the wall)	Main body: 173 x 52 x 30 mm Charger: 43 x 81 x 76 mm	82 x 111 x 39 mm
Weight	710 g	215 g	VL-V554: 405 g VL-V554U: 345 g	Main body: 160 g (including the batteries) Charger: 70 g (excluding the AC adaptor)	88 g (excluding the AC adaptor)
Operating environment	Ambient temperature: Approx. 0 °C to +40 °C Relative humidity (non-condensing): up to 90 %	Ambient temperature: Approx. 0 °C to +50 °C Relative humidity (non-condensing): up to 90 %	Ambient temperature: Approx. -15 °C to +50 °C Relative humidity (non-condensing): up to 90 % (tested up to -20 °C)	Ambient temperature: Approx. 0 °C to +40 °C Relative humidity (non-condensing): up to 90 %	Ambient temperature: Approx. 0 °C to +40 °C Relative humidity (non-condensing): up to 90 %
Display	7-inch wide colour / WVGA (800x480 pixels)	-	-	2.2-inch colour / QVGA (320x240 pixels)	-
Display language	English, Arabic	-	-	English, Arabic	-
Talking method	Hands-free	-	-	Hands-free	-
Frequency range	1.88 GHz to 1.90 GHz	-	-	1.88 GHz to 1.90 GHz	1.88 GHz to 1.90 GHz
Viewing angle	-	-	Horizontally: Approx. 170° Vertically: Approx. 115°	-	-
Image sensor / camera (pixel)	-	-	CMOS sensor (Approx. 1.0 M pixels)	-	-
Installation method	Wall mount (mounting bracket supplied)	Wall mount or attach to DIN rail	VL-V554: surface mount (mounting base supplied) VL-V554U: Flush mount (Flush mounting box supplied)	-	-
Minimum illuminance required	-	-	1 lx (within approx. 50 cm from the camera lens)	-	-
Lighting method	-	-	Warm white coloured LED lights, Infrared LEDs	-	-
Transmitting range	-	-	-	Approx. 100 m (line-of-sight distance from the main monitor)	Approx. 100 m (line-of-sight distance from the main monitor)
IP rating / IK rating	-	-	IP54 ² / Compliant with IK07	-	-
External material	Flame retardant PC+ABS resin, Flame retardant ABS resin	Flame retardant PC+ABS resin	Aluminium and flame retardant PC+PS resin	ABS resin	PS resin

*1 When sub monitors and extension monitors are used together, a total of up to 6 sub monitors and extension monitors can be registered.

*2 Water resistance is only assured if the doorphone is installed correctly according to the instructions in the Installation Guide, and appropriate water protection measures are taken.

Installing the Doorphone

• VL-V554 (Surface mount)

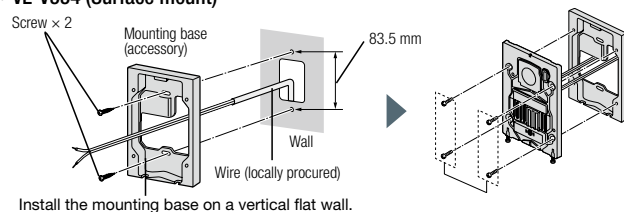

• Installation Position

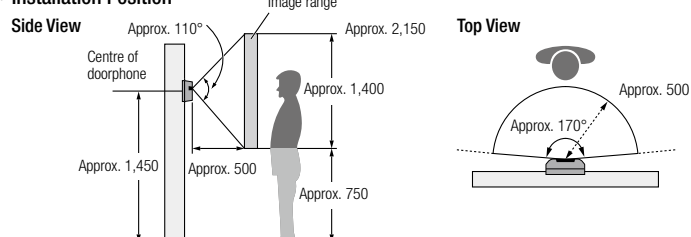

Installing the Main Monitor/Extension Monitor

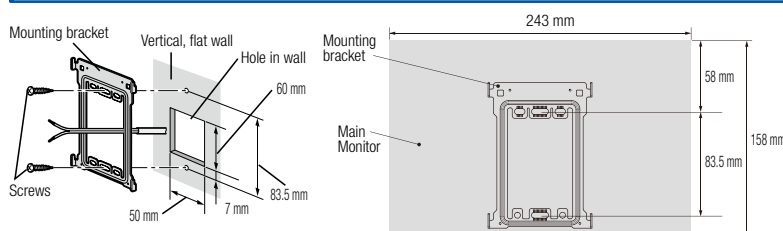

Installing the Power Supply Unit

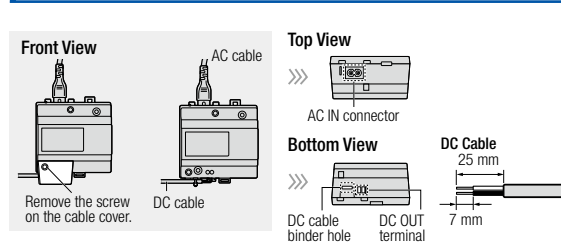

Important

– Safety Precaution: carefully read the operating instructions and installation manual before using this product.

- The actual product may vary slightly from photograph.
- Weights and dimensions are approximate.
- Design and Specifications are subject to change without notice.
- These products may be subject to export control regulations.

DISTRIBUTED BY :

Panasonic