

Specification:

Model	Model No.	BV52	RV52	DF52	F52
Cameras	Image Sensor	1/2.8" 2.1MP CMOS			
	Max. Resolution	Full HD (1920 x1024) + Full D1 30fps			
	Minimum Illumination	Color: 0.05Lux @ F1.4B/W; 0.02Lux @ F1.4 AGC ON			
	WDR	dWDR			
	DNR	3D -MCTF digital noise reduction			
	Shutter Speed	1/10000s to 1/25s			
	LENS	f (2.8mm~12mm), Angle:92°~27.2°		f(4mm) Angle: 78°x62.4°	optional
	IR distance	monitoring distance: 20m~30m			No IR
Compression	Video Compression	H.264 High Profile @Level 5.1/ MJPEG, 32 Kbps ~ 8Mbps			
Video Image	Day and Night Mode	Automatic, timing, manual and alarm trigger			
Network Function	Protocols	IPv4, TCP/IP, UDP, HTTP, DHCP, RTP/RTCP/RTSP, FTP, UPnP, DDNS, NTP, IGMP, ICMP			
	Compatible Protocols	ONVIF, GB/T 28181			
	Security	Password protect, multi-user access control			
	API Integration	Supply SDK, mobile APP HD Live and matched NVR and CMS video management platform software.			
Interfaces	Video Output	1channel CVBS standard definition composite video output(BNC interface, 1.1Vp-p±10%, RL=75Ω)			
	Communication Interfaces	1*RJ45 10M/100M self-adaption Ethernet port			
Basic Parameters	Work Environment	-20°C~55°C, 20-80% RH (non-condensing)			
	Power Supply	DC12V±10%			
		DC12V / PoE			
	Consumption	<5W MAX			

DIMENSIONS (mm):

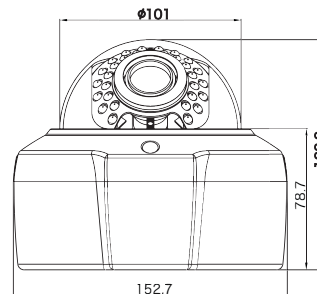
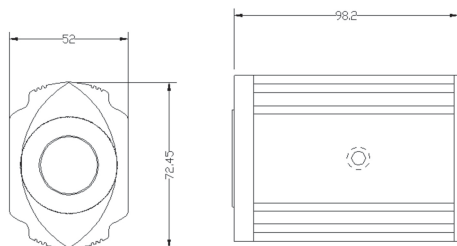
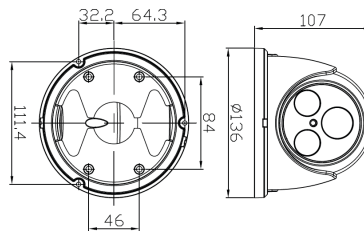
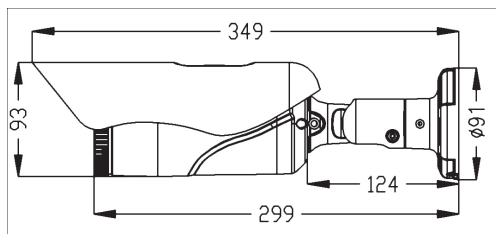

The specifications and appearance of the products may changed without notice